

CHARGEit Stand USERMANUEL





THANK YOU!

Thank you for purchasing the CHARGEit Stand from SACKit. Please read the entire instruction manual before using the product and save it for future reference. We reserve the right to change or update information and to correct errors, inaccuracies, or omissions in text, images, and technical data. If you have any questions regarding technical problems, please contact our customer services. We hope you will enjoy your new CHARGEit Stand.

Let SACKit power your life!

BOX CONTENT

- 1 x CHARGEit Stand
- 1 x CHARGEit Stand carrying bag
- 1 x Quick start guide
- 1 x USB-C charging cable

QUICK START GUIDE

Use CHARGEit while in power supply

1. Plug CHARGEit Stand to a power supply with the USB-C cable (adapter not included)
2. You can use wireless charging by placing your unit on the X if the unit supports wireless charging
3. You can use cabled charging by plugging in the cable from your unit to the CHARGEit Stand USB-port
4. Above mentioned point 2 and 3 can also be combined when CHARGEit is plugged into a power supply

Use CHARGEit Stand as a power bank (no power supply)

1. Charge CHARGEit Stand for 3 hours minimum for full power bank
2. Switch CHARGEit Stand on by pressing the POWER button
3. You can use wireless charging by placing your unit on the X if unit supports wireless charging
4. You can use cabled charging by plugging in the cable from your unit to the USB-port
5. You can charge one unit wirelessly and one unit cabled simultaneously
6. CHARGEit Stand will switch off automatically when not in use for one minute
7. Do not charge your device wirelessly with a steel plate or magnetic back, this may damage your devices

Correct storage and transportation of CHARGEit

1. When you need to take CHARGEit Stand on the go please use the included carrying bag to protect the beautiful surface of the power bank
2. CHARGEit Stand needs to be carried in your hand luggage when flying

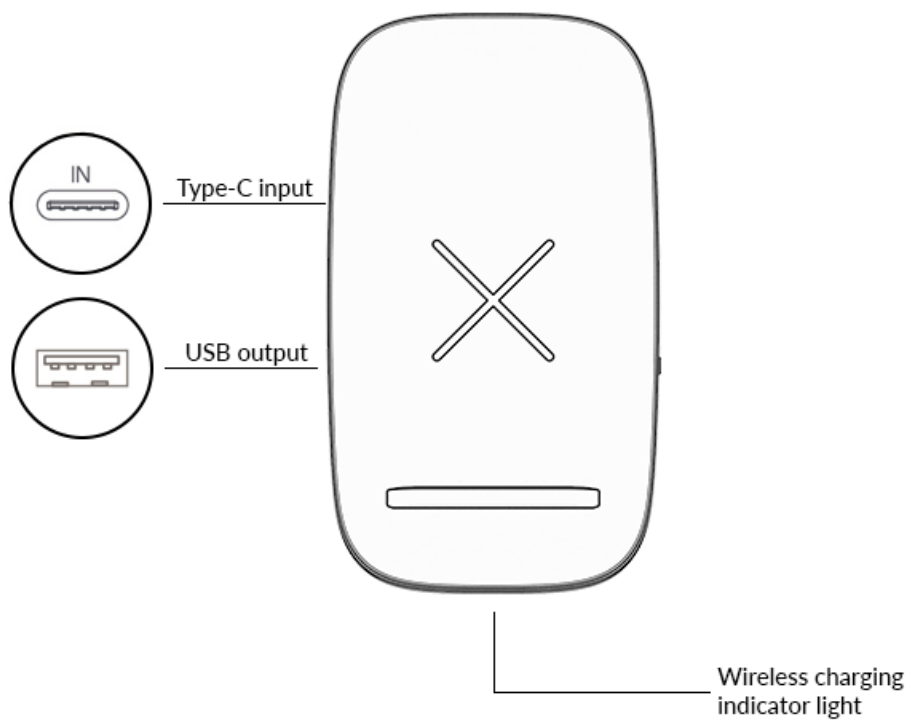

USER MANUAL

Functions:

- **USB Type-C input:** Here you need to connect the included charging cable to power CHARGEit Stand.
- **USB output:** Here you can connect devices to be charged via cable
- **Power-On LED indicator:** The green LED light will switch on for 10 sec when the charging cable is plugged in
- **Wireless Charging LED indicator:** The blue LED light will switch on for 30 sec when wireless charging is active

FIRST USE

1. Connect an adapter to a power outlet. See page 6 for a guide to choosing the correct adapter
2. Connect the included cable (USB side) to the adapter
3. Plug the USB-C side of the charging cable in to CHARGEit Stand

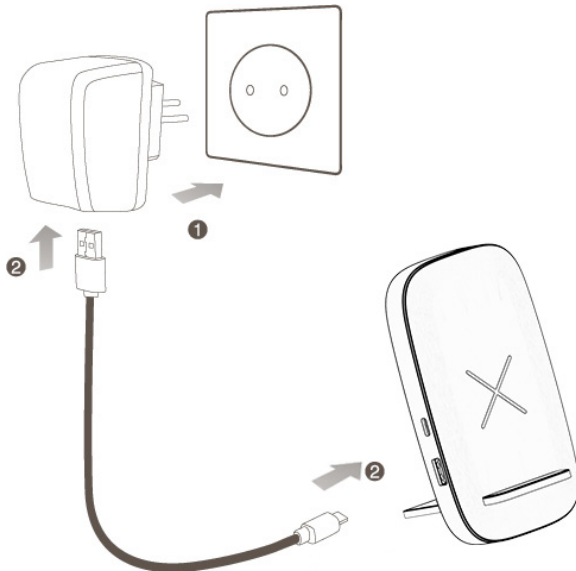

CHOOSE CORRECT ADAPTER FOR CHARGEIT STAND

Choosing the correct adapter is very important for your safety and the function of CHARGEit Stand. There are different options for adapters as described below:

1. QC2.0 output 5V/2A, 9V/1.67A
2. QC3.0 output 5V/3A, 9V/2A, 12V/1.5A

SACKit recommends that you choose a QC2.0 or QC3.0 adapter to achieve the best stability and function of CHARGEit Stand. Using a QC1.0 adapter may result in an overheated CHARGEit or device which may damage the product. SACKit will not be responsible for any issues or safety hazards arising from the use of a QC1.0 adapter. QC2.0 and QC3.0 adapters can be purchased on various websites.

TROUBLESHOOTING

If you have trouble using your CHARGEit Stand we ask you to try the following solutions. If these solutions does not fix your problem please contact our customer service at info@sackit.dk.

CHARGEit Stand charges slowly

- Check that all cables are connected correctly
- Make sure you have chosen either a QC2.0 or QC3.0 adapter

The blue LED indicator is blinking and the phone is not charging

- Make sure your phone is placed correctly on the X in the middle of CHARGEit Stand
- Power ON/OFF your phone and retry
- Make sure your phone supports wireless charging

I feel CHARGEit Stand is charging my device too slowly

- CHARGEit Stand only supports Fast Charging if your device supports the feature. Also you need to use a QC2.0 or QC3.0 adapter. See page 6

My device or CHARGEit Stand is very warm

- You need to ensure you have chosen the correct adapter for CHARGEit Stand. See page 6 for a guide
- The wireless charger must not be covered as this might result in overheating

CLEANING OF THE PRODUCT

1. Kindly switch off CHARGEit Stand before you clean it and remove it from the power supply
2. Do not use any chemicals to clean the product. If you need to clean the power bank please use a soft cloth with a mild cleaner
3. During cleaning please be aware to avoid water in the USB port. Large amounts of water and fluids may damage CHARGEit Stand

TECHNICAL SPECIFICATIONS

- Model: CHARGEit Stand - Wireless Charger and power bank
- Material: ABS + PC, Aluminium
- Input: 5V/2A 9V/1.67A
- Qi output: 5W, 7.5W, 10W
- Number of charging coils: 3
- Distance for Qi wireless pad: <8mm
- Conversion: >72%
- Frequency: 110-205KHz
- Size: 140*80*24mm
- Weight: 380g

IMPORTANT SAFETY INFORMATION

Please read the following information and operate the charger and accessories accordingly to ensure correct and safe use of the product. We are not responsible for damage caused by failure to comply with the instructions or irresponsible use of the product.

Warning

To prevent any fires or electrical hazards please act according to the following guidelines:

- Do not disassemble or replace any parts of this device. Please contact professional maintenance or qualified service center if there is any damage to the device.
- Do not expose this device to rain, water or wet places. Do not place liquid containers on the product side.
- Do not place in or close to any liquid
- If any liquids flows inside the product, please shut down the product and contact customer service center
- Do not place this device in or close to sources of excessive heat or fire. (Such as: candles, fireplaces or direct sunlight)
- Please shut down in lightning weather
- Keep this device away from any dust and vibration.
- Do not use excessive force when using the product.
- If the product is below 5°C when you receive it, please open the product packaging and wait for it to reach room temperature.
- To prevent overheating of the product is it necessary to keep a cleared area of 10 cm around the product
- Be sure to place this device on stable, flat and level surfaces only.
- Do not charge your device wirelessly with a steel plate or magnetic back, this may damage your devices
- To prevent overheating, please do not install the charger in enclosed spaces. Be sure to set aside at least 10 cm around the product for ventilation

DISPOSAL OF THE PRODUCT

CHARGEit Stand is made from recyclable and high quality materials. Do not dispose of together with living garbage. Please understand the local classification about collecting electronical, electrical products that contains batteries. Correct disposal of the product will help to prevent negative impact to the environment.

SACK^{it}®